

# ROYAL LED

# THORN

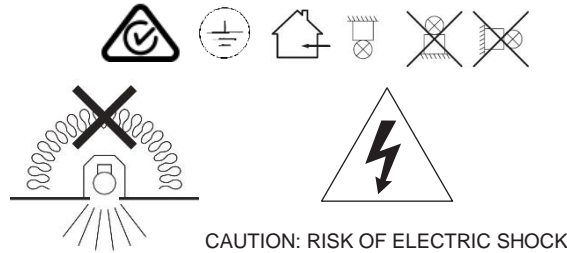

## Installation Instructions

- Please read these instructions carefully before installation. For commercial / industrial use only.
- Must be installed by a licensed electrician in accordance with local wiring regulations.
- Warranty is subject to installation being carried according to these instructions.
- Disconnect mains power supply before installing, servicing or maintaining the luminaire.
- The light source contained in this luminaire shall only be replaced by the manufacturer or his service agent or a similar qualified person.
- Warning: if the external flexible cable or cord of this luminaire is damaged, it shall be exclusively replaced by the manufacturer or his service agent or similar qualified person in order to avoid a hazard.
- Warning Do Not Cover luminaire, risk of overheating or fire if the clearance distances are compromised.
- The minimum clearance distance from the top of the luminaire to any normally flammable building element or insulation is 100mm.
- The minimum clearance distance from the sides of the luminaire to any normally flammable building element or insulation is 50mm.
- Changes to design; we reserve the right to change the design and/or specification without prior notice.

## A: T-BAR CEILING

1 - Remove the ceiling tile

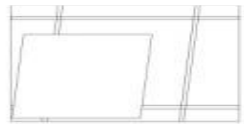

(Picture 1)

2 - Connect the Flex and Plug

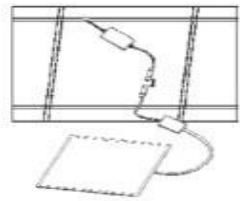

(Picture 2)

3 - Fit the panel in the T-bar

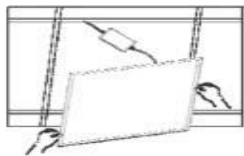

(Picture 3)

4 - Re-connect the power

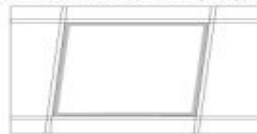

(picture 4)

NOTE: Please order Project Plaster Frame (PPF) for **plasterboard ceiling** installations:

|              |          |
|--------------|----------|
| PPF 1200x300 | 96062559 |
| PPF 600x300  | 96065871 |
| PPF 600x600  | 96065872 |

## B: SURFACE MOUNT KIT

1 - Fix the Surface Mounting kit to the ceiling



(Picture 1)

2 - Connect the Flex and Plug

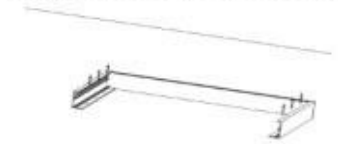

(Picture 2)

3 - Slide the Royal LED fitting in the frame



(Picture 3)

4 - Close the frame and re-connect the power



(Picture 4)

ROYAL LED SURFACE MOUNTING KIT 12x3  
ROYAL LED SURFACE MOUNTING KIT 6x6

96540976  
96540977

## C: WIRE SUSPENSION KIT

1 - Fix the Surface Mounting holders to the ceiling

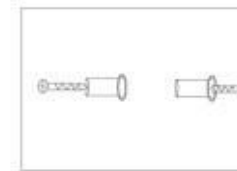

(Picture 1)

2 - Install the Suspension cables

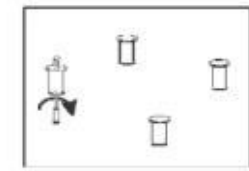

(Picture 2)

3 - Install Royal LED fitting to the Suspension Kit

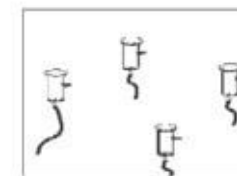

(Picture 3)

4 - Connect Flex and Plug and re-connect power



(Picture 4)

ROYAL LED WIRE SUSPENSION KIT (1.5M)

96541122

ZG LIGHTING AUSTRALIA PTY LTD  
2/7 Millner Avenue Horsley Park  
NSW 2175 AUSTRALIA  
ABN: 35 002 281 601  
1300 139 965

Projectquotes@zumtobelgroup.com  
www.thornlighting.com.au